

# Site Plan - DA Approved (DA-775/2005/2)

1

1 : 200

Mahn Design © COPYRIGHT Reproduction of the whole or part of the document constitutes and infringes copyright. The information, ideas and concepts contained in this document is/are confidential. The recipient(s) of this document is/are prohibited from disclosing such information ideas and concepts to any person without prior written consent of the copyright holder. Contractor to check and verify all levels, datums & dimensions on site and shall report any discrepancies or omissions to this office prior to start of work & during the construction phase. This drawing is to be read and understood in conjunction with structural, mechanical, electrical and or any other consultant/s documentation as may be applicable to the project prior to start of work & it's duration. Measurement scaling of this drawing shall only be permitted in its digital form.

REV	DATE	DESCRIPTION	INITIAL
A	02.06.2022	Issued for Site Inspection	A.J.
0	20.06.2022	Issued for DA	A.J.

DRAWING TITLE: Site Plan - DA Approved  
DRAWN BY: A.J.  
CHECKED BY: S.D.  
LOT: 25 | SEC: | DP: 792186

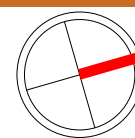

SITE ADDRESS: 48 Stacey Street Bankstown 2200  
CLIENT: GK (AUST) PTY LTD  
PROJECT TYPE: Proposed Additions & Alterations to Cafe  
DATE: 02.06.2022 REV: 0 SHEET NO: A101  
COUNCIL AREA: CB City SCALE 1 : 200

**MAHN DESIGN** **bdqa** ACCREDITED BUILDING DESIGNER

Suite 4/259 Northumberland St, Liverpool NSW 2170, Australia  
Ph: 02 8319 9447 | info@mahn.com.au | www.mahn.com.au

PROJECT NO: A-22006

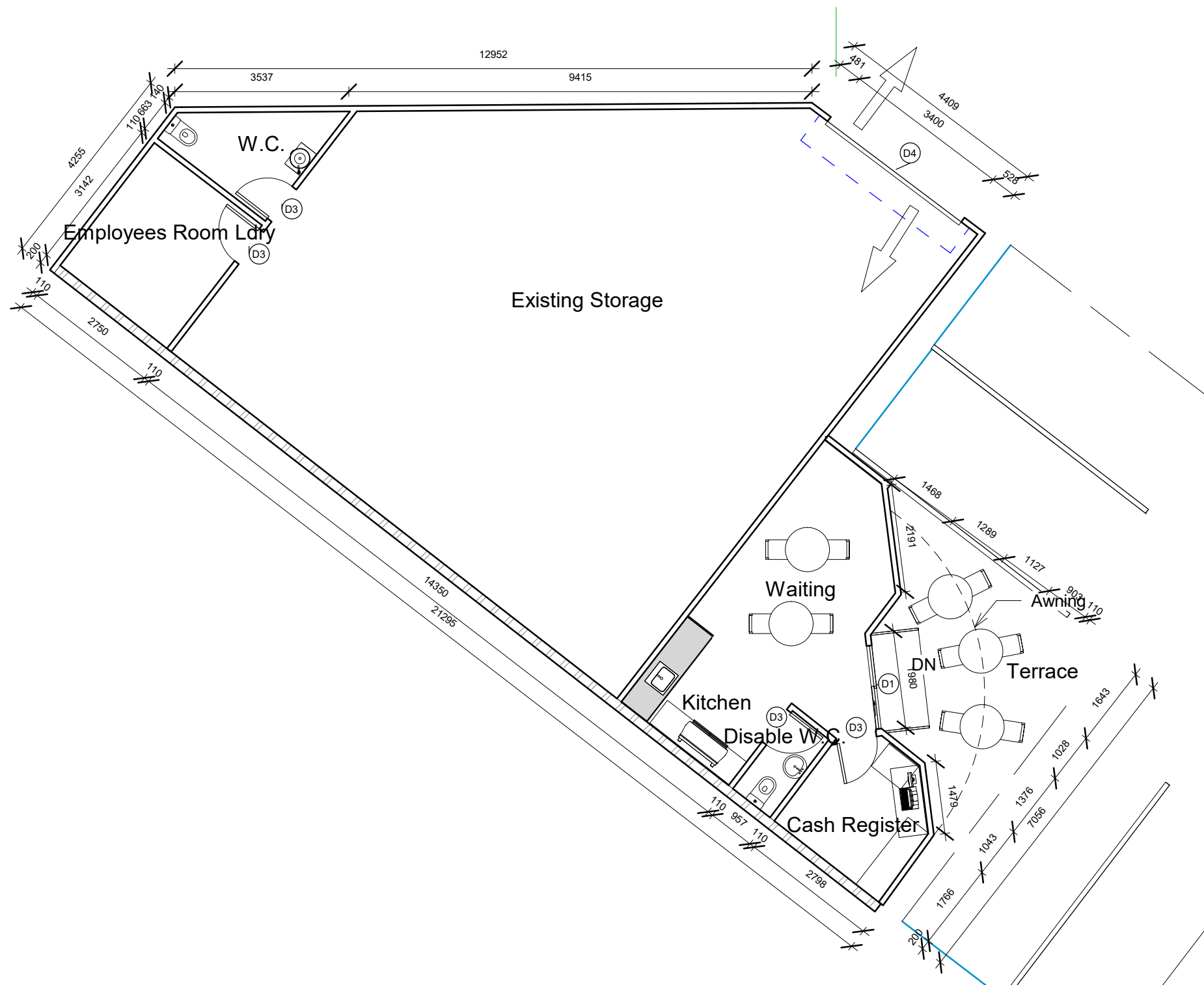

1

Floor Plan - DA Approved (DA-775/2005/2)

1 : 100

Mahn Design © COPYRIGHT Reproduction of the whole or part of the document constitutes and infringes copyright. The information, ideas and concepts contained in this document is/are confidential. The recipient(s) of this document is/are prohibited from disclosing such information ideas and concepts to any person without prior written consent of the copyright holder. Contractor to check and verify all levels, datums & dimensions on site and shall report any discrepancies or omissions to this office prior to start of work & during the construction phase. This drawing is to be read and understood in conjunction with structural, mechanical, electrical and or any other consultant/s documentation as may be applicable to the project prior to start of work & it's duration. Measurement scaling of this drawing shall only be permitted in its digital form.

REV	DATE	DESCRIPTION	INITIAL
A	02.06.2022	Issued for Site Inspection	A.J.
0	20.06.2022	Issued for DA	A.J.

DRAWING TITLE: Floor Plan - DA Approved  
DRAWN BY: A.J.  
CHECKED BY: S.D.  
LOT: 25 | SEC: | DP:792186

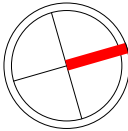

SITE ADDRESS: 48 Stacey Street Bankstown 2200  
CLIENT: GK (AUST) PTY LTD  
PROJECT TYPE: Proposed Additions & Alterations to Cafe  
DATE: 02.06.2022 REV: 0 SHEET NO: A102  
COUNCIL AREA: CB City SCALE 1 : 100

MAHN bdqa ACCREDITED BUILDING DESIGNER

Suite 4/259 Northumberland St, Liverpool NSW 2170, Australia  
Ph: 02 8319 9447 | info@mahn.com.au | www.mahn.com.au

PROJECT NO: A-22006

PLOT DATE: 1/07/2022 6:44:13 PM



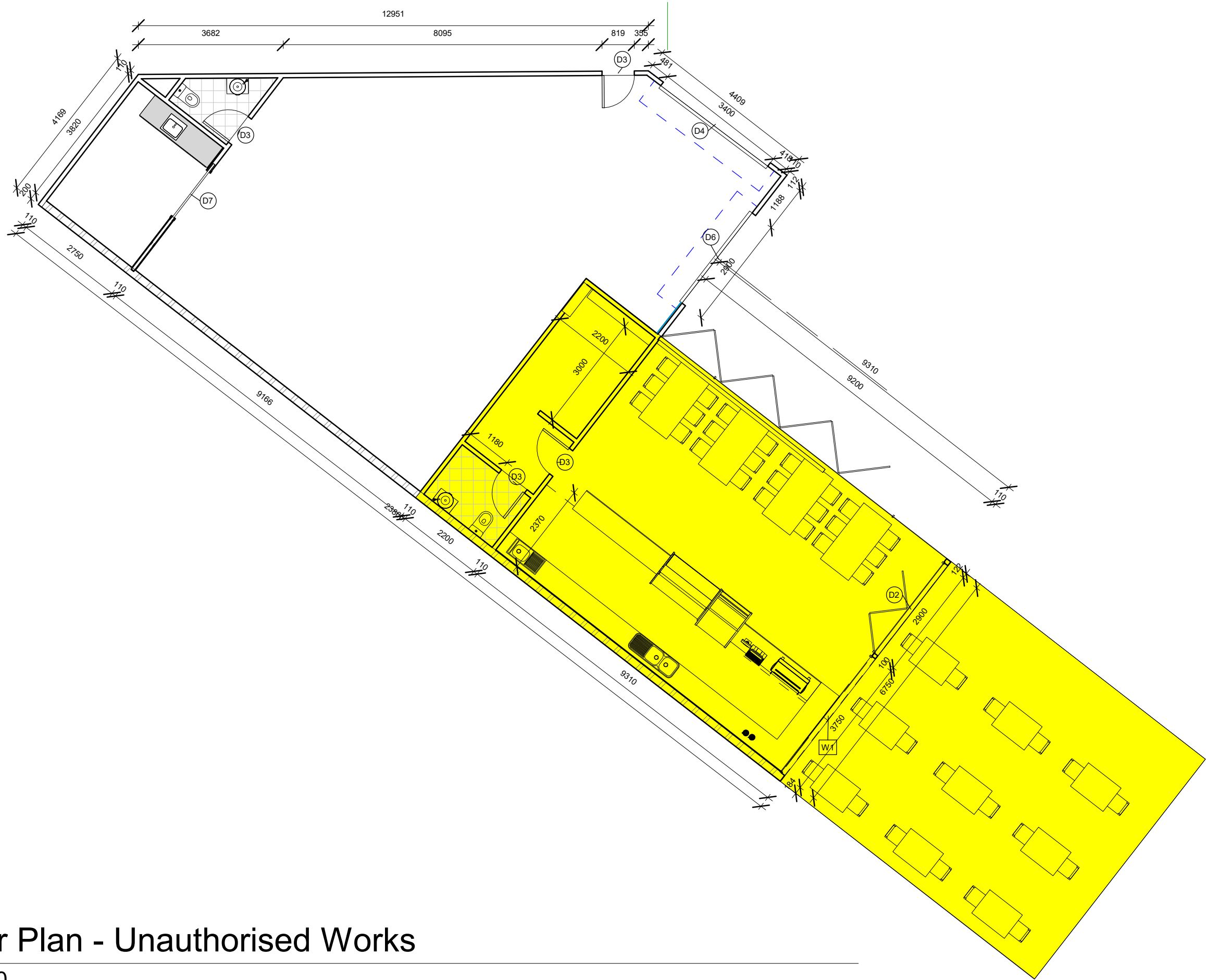

1

# Floor Plan - Unauthorised Works

1 : 100

REV	DATE	DESCRIPTION	INITIAL
0	20.06.2022	Issued for DA	A.J.

**DRAWING TITLE:** Floor Plan - Unauthorised Works  
**DRAWN BY:** A.J.  
**CHECKED BY:** S.D.  
**LOT: 25 | SEC: | DP: 792186**

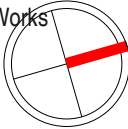

**SITE ADDRESS:** 48 Stacey Street Bankstown 2200  
**CLIENT:** GK (AUST) PTY LTD  
**PROJECT TYPE:** Proposed Additions & Alterations to Cafe  
**DATE:** 02.06.2022 **REV:** 0 **SHEET NO:** A104  
**COUNCIL AREA:** CB City **SCALE:** 1 : 100

**MAHN DESIGN** **bdqa** ACCREDITED BUILDING DESIGNER

Suite 4/259 Northumberland St, Liverpool NSW 2170, Australia  
Ph: 02 8319 9447 | info@mahn.com.au | www.mahn.com.au

PROJECT NO: A-22006



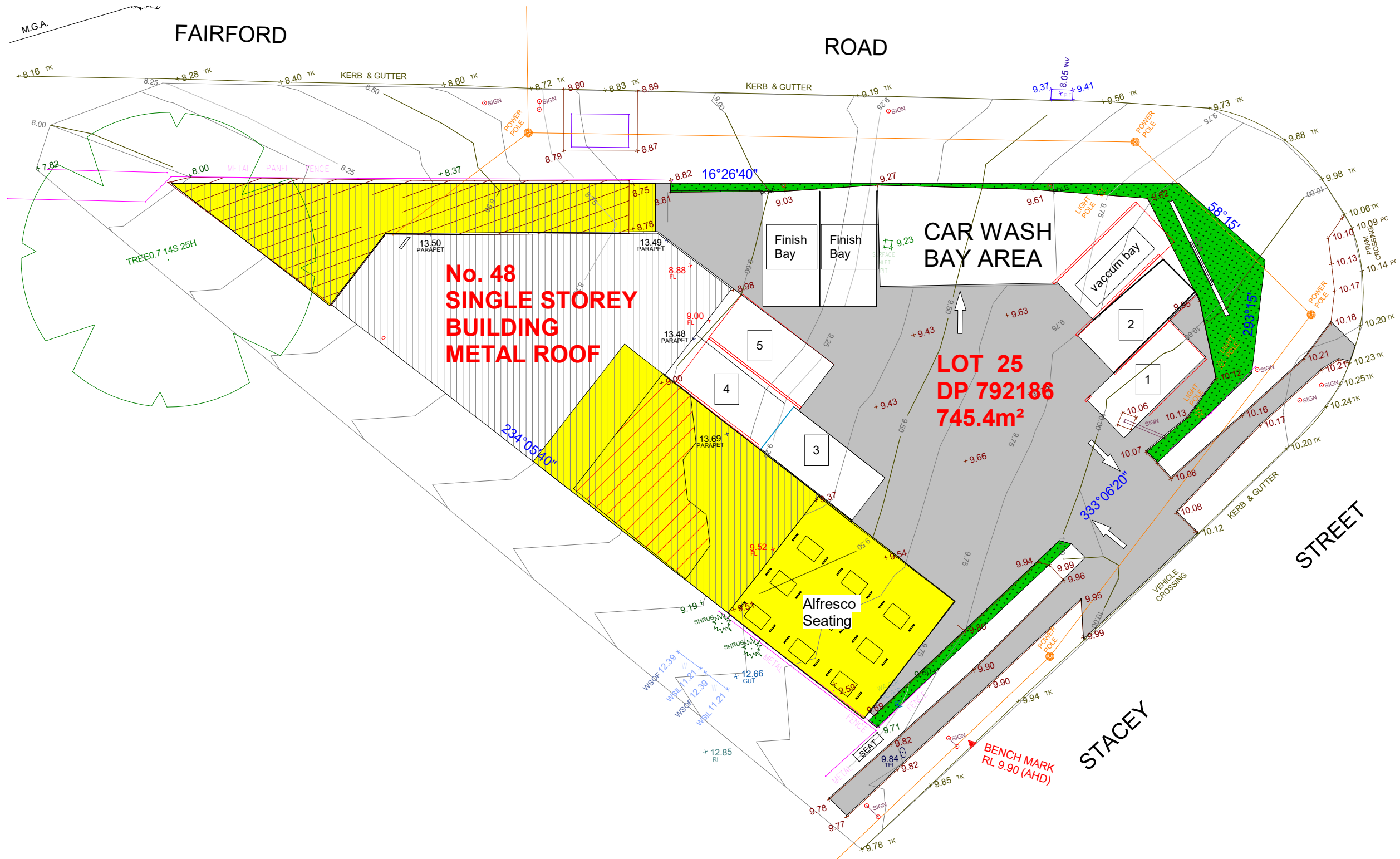

1

## Overlay of DA Approved and Unauthorised Works Site Plan

1 : 200

**Mahn Design** © COPYRIGHT Reproduction of the whole or part of the document constitutes and infringes copyright. The information, ideas and concepts contained in this document is/are confidential. The recipient(s) of this document is/are prohibited from disclosing such information ideas and concepts to any person without prior written consent of the copyright holder. Contractor to check and verify all levels, datums & dimensions on site and shall report any discrepancies or omissions to this office prior to start of work & during the construction phase. This drawing is to be read and understood in conjunction with structural, mechanical, electrical and or any other consultant/s documentation as may be applicable to the project prior to start of work & it's duration. Measurement scaling of this drawing shall only be permitted in its digital form.

REV	DATE	DESCRIPTION	INITIAL
0	20.06.2022	Issued for DA	A.J.

**DRAWING TITLE:** Overlay - Site Plan  
**DRAWN BY:** A.J.  
**CHECKED BY:** S.D.  
**LOT: 25 | SEC: | DP: 792186**

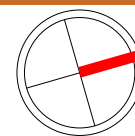

**SITE ADDRESS:** 48 Stacey Street Bankstown 2200  
**CLIENT:** GK (AUST) PTY LTD  
**PROJECT TYPE:** Proposed Additions & Alterations to Cafe  
**DATE:** 02.06.2022 **REV:** 0 **SHEET NO:** A105  
**COUNCIL AREA:** CB City **SCALE:** 1 : 200

**MAHN DESIGN** **bdqa** ACCREDITED BUILDING DESIGNER  
Suite 4/259 Northumberland St, Liverpool NSW 2170, Australia  
Ph: 02 8319 9447 | info@mahn.com.au | www.mahn.com.au

PROJECT NO: A-22006



LEGEND	
	Exisitng Walls
	DA Approved Walls - not constructed
	Unauthorised constructed walls

1

Overlay of DA Approved and Unauthorised works - Floor Plan

1 : 100

REV	DATE	DESCRIPTION	INITIAL
0	20.06.2022	Issued for DA	A.J.

DRAWING TITLE: Overlay - Floor Plan  
DRAWN BY: A.J.  
CHECKED BY: S.D.  
LOT: 25 | SEC: | DP:792186

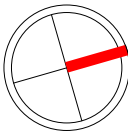

SITE ADDRESS: 48 Stacey Street Bankstown 2200  
CLIENT: GK (AUST) PTY LTD  
PROJECT TYPE: Proposed Additions & Alterations to Cafe  
DATE: 02.06.2022 REV: 0 SHEET NO: A106  
COUNCIL AREA: CB City SCALE 1 : 100

**MAHN DESIGN** ACCREDITED BUILDING DESIGNER

Suite 4/259 Northumberland St, Liverpool NSW 2170, Australia  
Ph: 02 8319 9447 | info@mahn.com.au | www.mahn.com.au

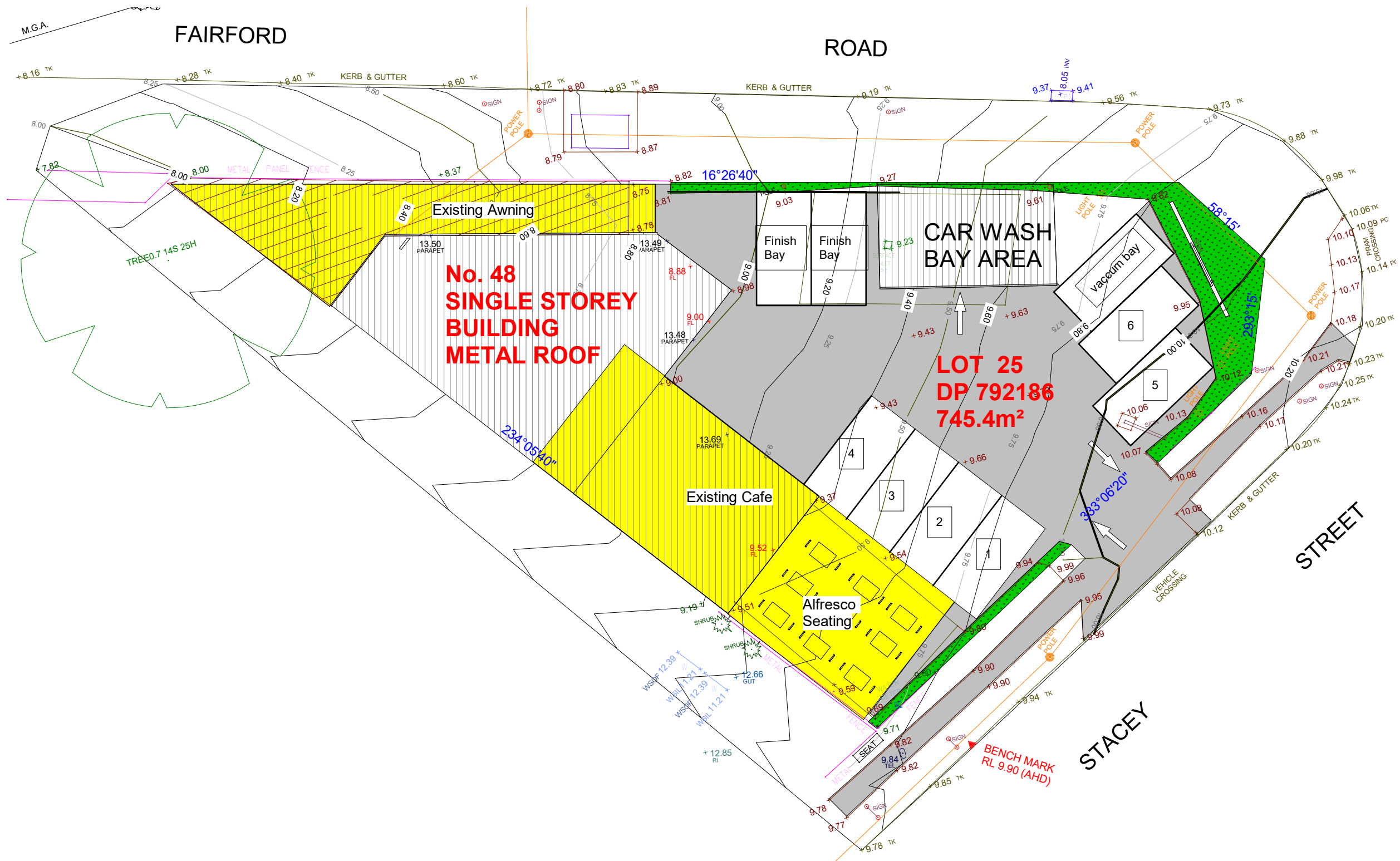

# Proposed Site Plan and Parking Layout

1 : 200

**Mahn Design** © COPYRIGHT Reproduction of the whole or part of the document constitutes and infringes copyright. The information, ideas and concepts contained in this document is/are confidential. The recipient(s) of this document is/are prohibited from disclosing such information ideas and concepts to any person without prior written consent of the copyright holder. Contractor to check and verify all levels, datums & dimensions on site and shall report any discrepancies or omissions to this office prior to start of work & during the construction phase. This drawing is to be read and understood in conjunction with structural, mechanical, electrical and or any other consultant/s documentation as may be applicable to the project prior to start of work & it's duration. Measurement scaling of this drawing shall only be permitted in its digital form.

REV	DATE	DESCRIPTION	INITIAL
0	20.06.2022	Issued for DA	A.J.

**DRAWING TITLE:** Proposed Site Plan and Parking Layout  
**DRAWN BY:** A.J.  
**CHECKED BY:** S.D.  
**LOT: 25 | SEC: | DP: 792186**

**SITE ADDRESS:** 48 Stacey Street Bankstown 2200  
**CLIENT:** GK (AUST) PTY LTD  
**PROJECT TYPE:** Proposed Additions & Alterations to Cafe  
**DATE:** 02.06.2022 **REV:** 0 **SHEET NO:** A107  
**COUNCIL AREA:** CB City **SCALE:** 1 : 200

**MAHN DESIGN** **bdqa** ACCREDITED BUILDING DESIGNER  
Suite 4/259 Northumberland St, Liverpool NSW 2170, Australia  
Ph: 02 8319 9447 | info@mahn.com.au | www.mahn.com.au

PROJECT NO: A-22006

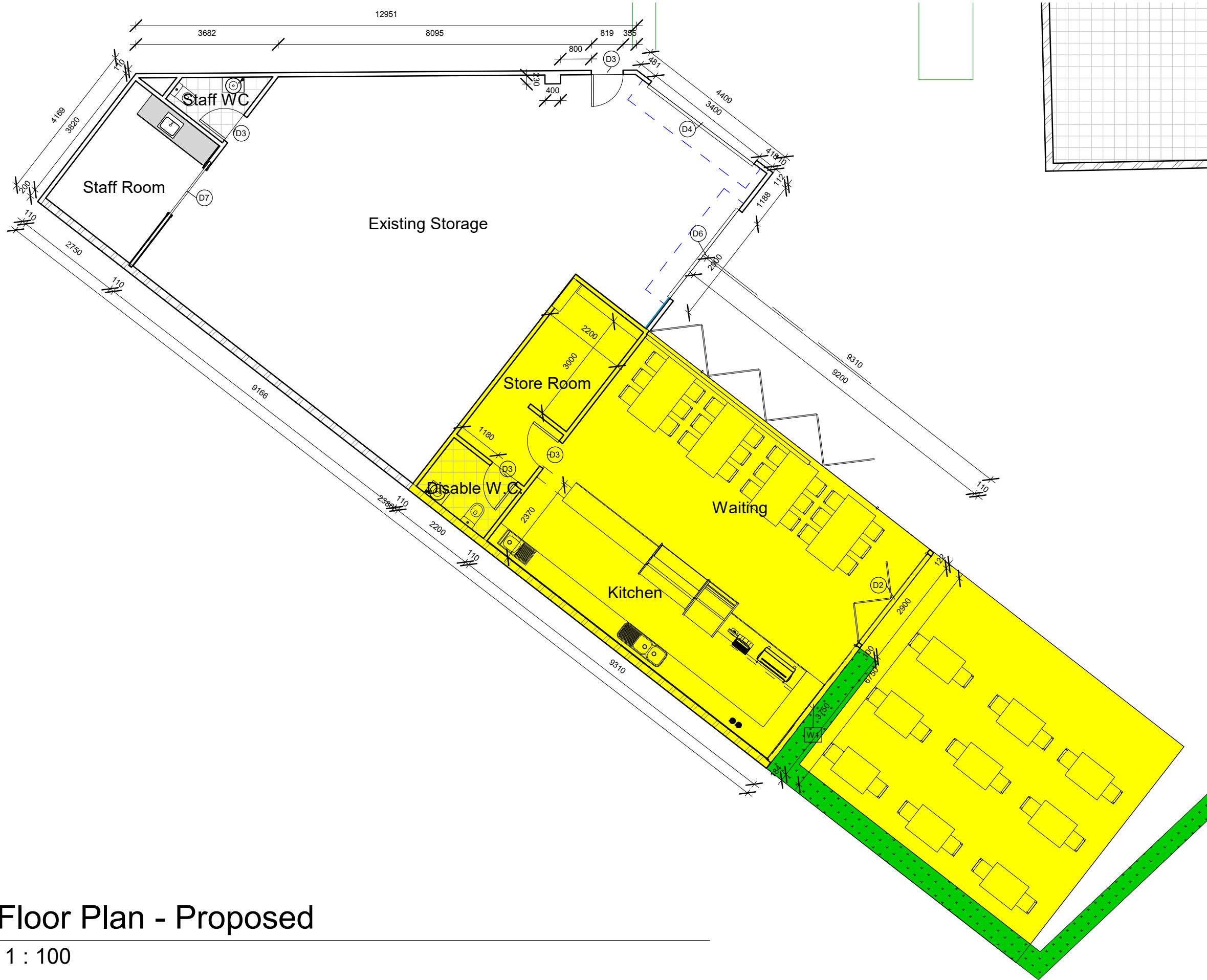

1 Floor Plan - Proposed  
1 : 100

REV	DATE	DESCRIPTION	INITIAL
0	20.06.2022	Issued for DA	A.J.

DRAWING TITLE: Proposed Floor Plan  
DRAWN BY: A.J.  
CHECKED BY: S.D.  
LOT: 25 | SEC: | DP: 792186

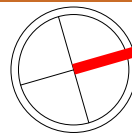

SITE ADDRESS: 48 Stacey Street Bankstown 2200  
CLIENT: GK (AUST) PTY LTD  
PROJECT TYPE: Proposed Additions & Alterations to Cafe  
DATE: 02.06.2022 REV: 0 SHEET NO: A108  
COUNCIL AREA: CB City SCALE 1 : 100

**MAHN DESIGN** **bdqa** ACCREDITED BUILDING DESIGNER

Suite 4/259 Northumberland St, Liverpool NSW 2170, Australia  
Ph: 02 8319 9447 | info@mahn.com.au | www.mahn.com.au

PROJECT NO: A-22006

PLOT DATE: 1/07/2022 6:44:42 PM



